

FLOOR PLAN ABBREVIATIONS:

B.F.	B-FOLD DOOR
S.G.D.	SLIDING GLASS DOOR (TEMP.)
O.H.	OVER HEAD
BYP.	BY-PASS DOOR
FR. DR.	FRENCH DOOR
P.K.T.	POCKET DOOR
HC	HOLLOW CORE
SC	SOLID CORE
CASE	CASEMENT WINDOW
S.H.	SINGLE HUNG WINDOW
AWN.	AWNING WINDOW
H.R.	HORIZONTAL ROLLER WINDOW
TEMP.	TEMPERED
MIRR.	MIRROR
W/C	WATER CLOSET
LAV.	LAVATORY
SHWR.	SHOWER
EWH	ELECTRIC WATER HEATER
GWH	GAS WATER HEATER
T.G.S.E.	CATEGORY II TEMPERED GLASS SHOWER ENCLOSURE
C.V.	CENTRAL VACUUM
2880	SIZE NOMENCLATURE: 2'-8" WIDE X 8'-0" HI

WALL LEGEND:

SYMBOL:	DESCRIPTION:
[Symbol]	EXTERIOR C.M.U. WALL
[Symbol]	LOAD-BEARING FRAME PARTITION
[Symbol]	PARTITION WBATT INSULATION
[Symbol]	PARTITION W/SOUND INSULATION
[Symbol]	PARTITION

AREA CALCULATIONS

LIVING AREA (A/C AREA):	
FIRST FLOOR LIVING AREA	2,497.3 SQ.FT.
SECOND FLOOR LIVING AREA	2,754.7 SQ.FT.
TOTAL LIVING AREA:	5,252.0 SQ.FT.
NON A/C AREA:	
GARAGE 1 AND 2 TOTAL=	712.2 SQ.FT.
COVERED ENTRY	70.0 SQ.FT.
COVERED PATIO	258.5 SQ.FT.
COVERED TERRACE	258.5 SQ.FT.
TOTAL NON LIVING AREA:	1,298.2 SQ.FT.
TOTAL AREA:	6,550.2 SQ.FT.

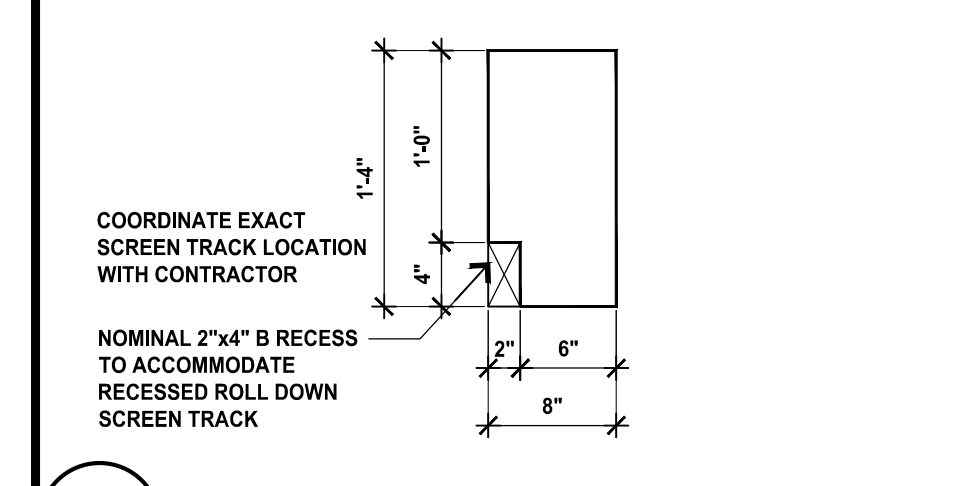

1
A1.0 COLUMN @ COVERED PATIO DTL.

FIRST FLOOR PLAN SCALE 1/4" = 1'-0"

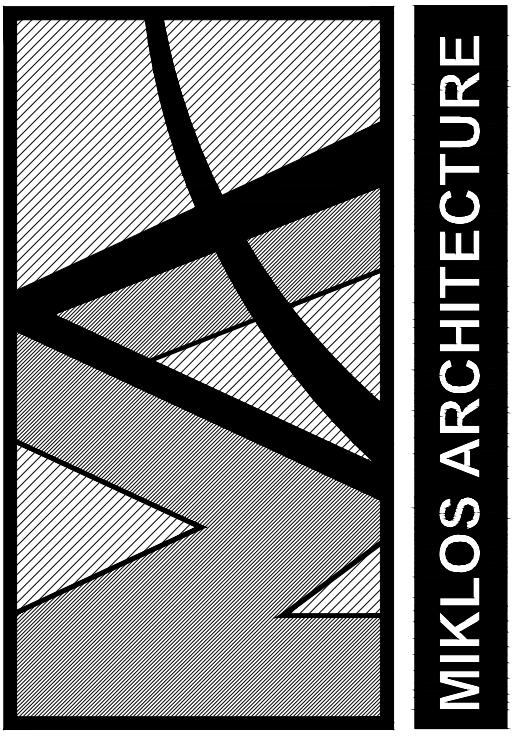

COPYRIGHT 2022 BY MIKLOS ARCHITECTURE ALL RIGHTS RESERVED

NO PART OF THIS PLAN OR DESIGN MAY BE REPRODUCED OR TRANSMITTED IN ANY FORM OR BY ANY MEANS, ELECTRONIC OR MECHANICAL, INCLUDING PHOTOCOPYING, RECORDING OR ANY INFORMATION RETRIEVAL SYSTEM, WITHOUT THE WRITTEN APPROVAL OF MIKLOS AND ASSOCIATES P.A. NO DERIVATIVE WORKS OF THIS PLAN MAY BE MADE WITHOUT PRIOR WRITTEN PERMISSION. THE CONTRACTOR SHALL VERIFY AND BE RESPONSIBLE FOR ALL DIMENSIONS AND CONDITIONS SPECIFIED ON THESE DRAWINGS. WRITTEN DIMENSIONS ON THESE DRAWINGS SHALL HAVE PRECEDENCE OVER SCALED DIMENSIONS. MIKLOS AND ASSOCIATES P.A. MUST BE NOTIFIED OF ANY DISCREPANCIES FOUND AND ASSUMES NO LIABILITY FOR THE UNAUTHORIZED USE OF THESE PLANS, DRAWINGS AND SPECIFICATIONS.

PROPOSED RESIDENCE FOR:
ASKARI DEVELOPMENT GROUP
2420 NE 48TH STREET
LIGHTHOUSE POINT, FLORIDA

MIKLOS ARCHITECTURE ARCHITECTS/PLANNERS
2263 N.W. BOCA RATON BLVD., SUITE 112, BOCA RATON, FL 33431
PH. (561) 392-6762 E-MAIL: INFO@MIKLOSARCHITECTURE.COM
WWW.MIKLOSARCHITECTURE.COM

JOB	10622
DATE	APRIL 2022
DRAWN	MN/AH
CHKD	Q MIKLOS

REVISIONS

SHEET	A1.0
OF	-
SEAL	

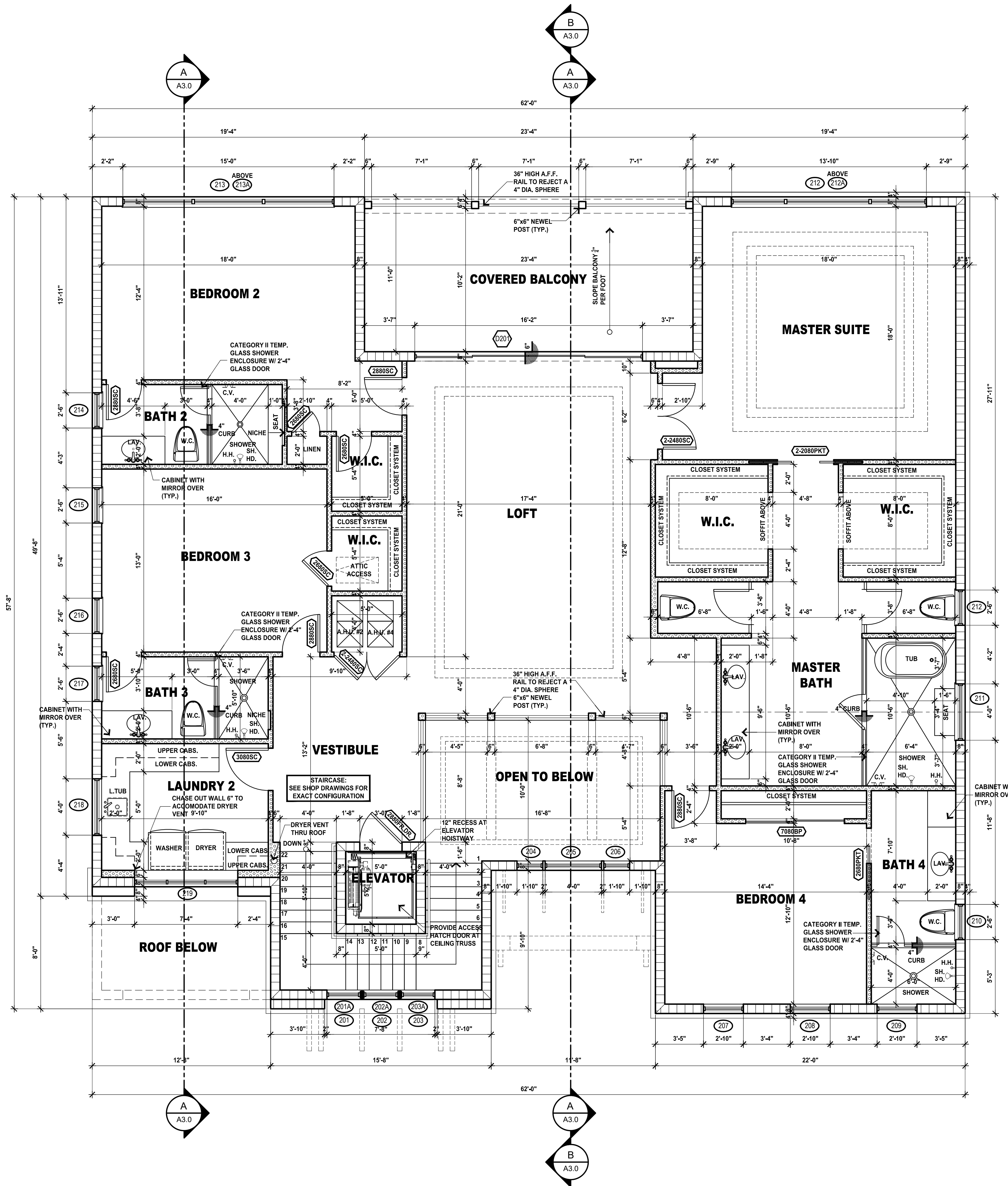

SECOND FLOOR PLAN

SCALE 1/4" = 1'-0"

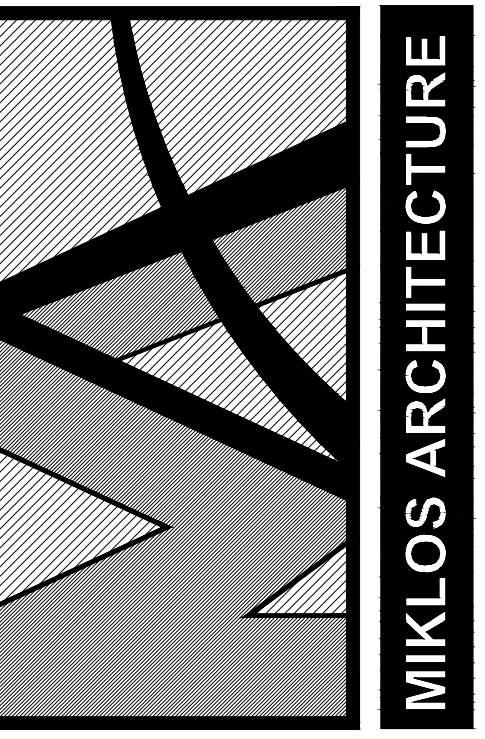

MIKLOS ARCHITECTURE

COPYRIGHT 2022 BY
MIKLOS ARCHITECTURE
ALL RIGHTS RESERVED

NO PART OF THIS PLAN OR DESIGN MAY BE REPRODUCED OR TRANSMITTED IN ANY FORM OR BY ANY MEANS, ELECTRONIC OR MECHANICAL, INCLUDING PHOTOCOPYING, RECORDING OR ANY INFORMATION RETRIEVAL SYSTEM, WITHOUT THE WRITTEN APPROVAL OF MIKLOS AND ASSOCIATES, P.A. NO DERIVATIVE WORKS OF THIS PLAN MAY BE MADE WITHOUT PRIOR WRITTEN PERMISSION. THE CONTRACTOR SHALL VERIFY AND BE RESPONSIBLE FOR ALL DIMENSIONS AND CONDITIONS SPECIFIED ON THESE DRAWINGS. WRITTEN DIMENSIONS ON THESE DRAWINGS SHALL HAVE PRECEDENCE OVER SCALED DIMENSIONS. MIKLOS AND ASSOCIATES, P.A. MUST BE NOTIFIED OF ANY DISCREPANCIES FOUND AND ASSUMES NO LIABILITY FOR THE UNAUTHORIZED USE OF THESE PLANS, DRAWINGS AND SPECIFICATIONS.

PROJECT
PROPOSED RESIDENCE FOR:
ASKARI DEVELOPMENT GROUP
2420 NE 48TH STREET
LIGHTHOUSE POINT, FLORIDA

SHEET CONTENTS
SECOND FLOOR PLAN

MIKLOS ARCHITECTURE ARCHITECTS/PLANNERS
2263 N.W. BOCA RATON BLVD., SUITE 112, BOCA RATON, FL 33431
PH. (561) 392-6762 E-MAIL: INFO@MIKLOSARCHITECTURE.COM
WWW.MIKLOSARCHITECTURE.COM

JOB	10622
DATE	APRIL 2022
DRAWN	MN/AH
CHKD	Q MIKLOS

REVISIONS

SHEET	A1.1
OF	-
SEAL	